

## Heating and cooling



# Inline asynchronous circulators for heating application

Type : RSL Ku and DY..Ku



Also available as Integrated Circulator

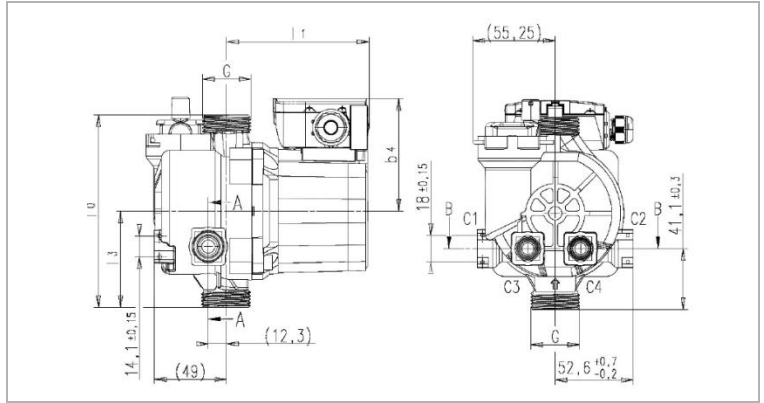

Connections G 1"

Suction and pressure side : screwed on minimum 3 threads

Maximal torque on connections G 1" : 40 Nm

Gasket :  $\varnothing 30 \times \varnothing 21 \times 2,1$  (EPDM)

This circulator housing can be supplied with 4 optional connections. They are defined to be connected to one manometer or one expansion vessel. It's also possible to receive (by C1 or C2) the connection from the boiler short circuit but the maximum water flow allowed in this case is 1700l/h. Any other use has to be tested and validated by Wilo Intec.

**C1**

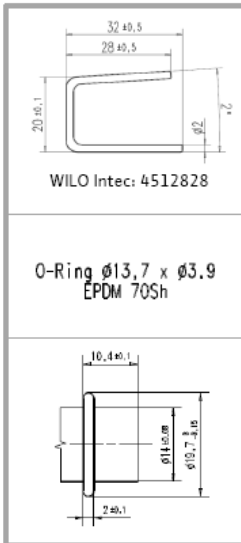

**C2**

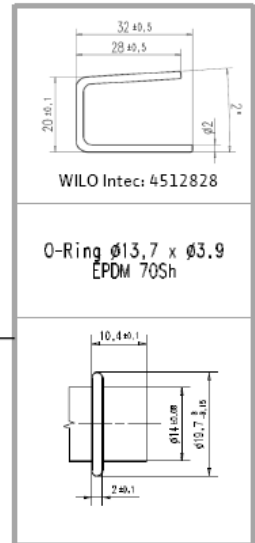

**C3**

**C4**

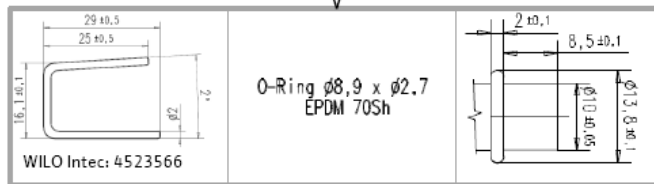

	Thread		Dimensions		
	G	l0	l3	l1	b4
RSL15/4 Ku – DY.33–15 Ku	1"	130	65	95,6	72,5
RSL15/Premium Ku – DY.Premium–15 Ku				95,6	72,5
RSL15/5 Ku – DY.43–15 Ku				95,6	72,5
RSL15/6 Ku – DY.53–15 Ku				95,6	76
RSL15/6 Compact Ku – DY.53–15 Compact Ku				95,6	72,5
RSL15/7 Ku – DY.63–15 Ku				108,6	76

## Inline asynchronous circulators for heating application

Type : RSL Ku and DY..Ku

	n l/min	P1 W	I A	Capacitor µf/VDB
RSL15/4 Ku DY.33-15 Ku	max 2150	62	0,28	2 / 400
	1650	45	0,21	
	min 1300	29	0,14	
RSL15/Premium Ku DY.Premium-15 Ku	max 2500	60	0,26	2 / 400
	2080	50	0,22	
	min 1800	34	0,15	
RSL15/5 Ku DY.43-15 Ku	max 2200	84	0,36	2 / 400
	2000	58	0,26	
	min 1700	38	0,17	

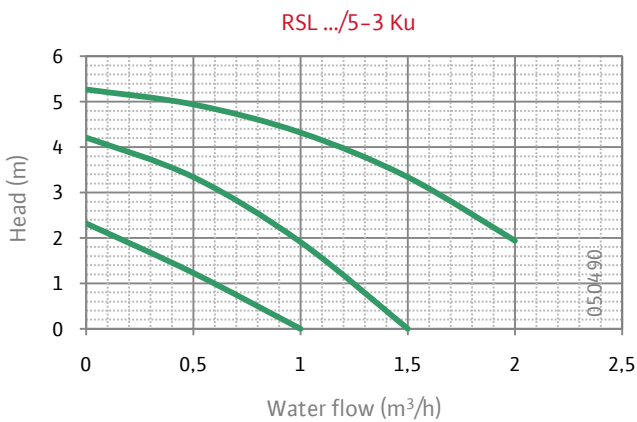
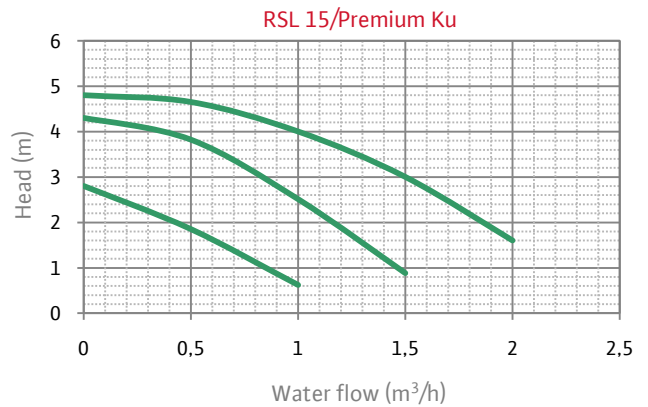
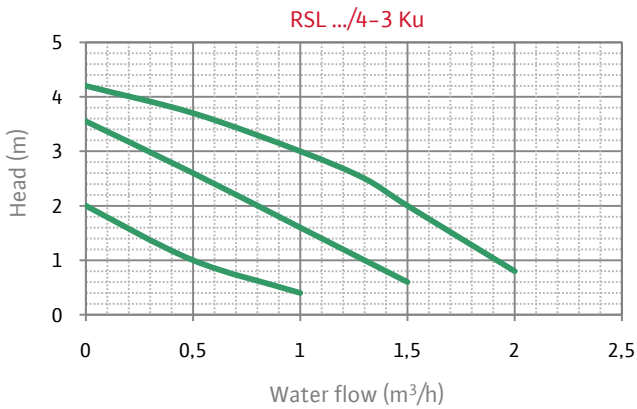

\* Test conditions :

- > Water flow rate set at nominal operation point
- > 400 cc air injected
- > Test according to Wilo Intec procedure

Nota bene : tolerances of each curve are according to EN 1151-1:2006

## Inline asynchronous circulators for heating application

### Type : RSL Ku and DY..Ku

		n l/min	P1 W	I A	Capacitor µf/VDB
RSL15/6 Ku DY.53-15 Ku	max	2400	86	0,39	2,6 / 400
		2000	63	0,29	
	min	1700	42	0,20	
RSL15/6 Compact Ku DY.53-15 Compact Ku	max	2400	83	0,36	2 / 400
		2000	57	0,26	
	min	1200	36	0,18	
RSL15/7 Ku DY.63-15 Ku	max	2500	116	0,52	3,5 / 400
		2200	88	0,41	
	min	2100	53	0,25	

RSL .../6-3 Ku

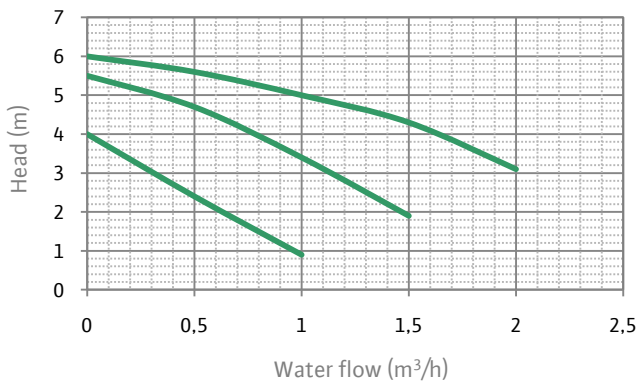

RSL .../6 Compact-3 Ku

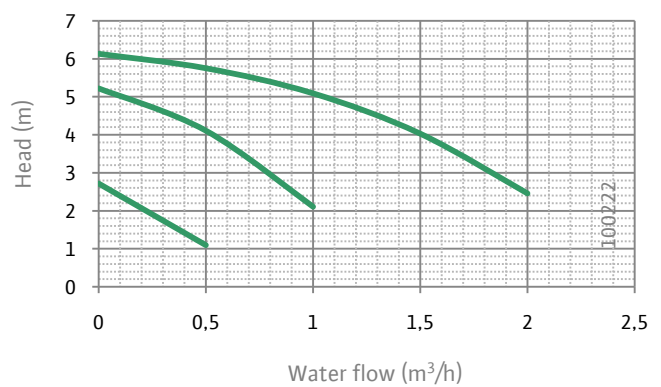

RSL .../7-3 Ku

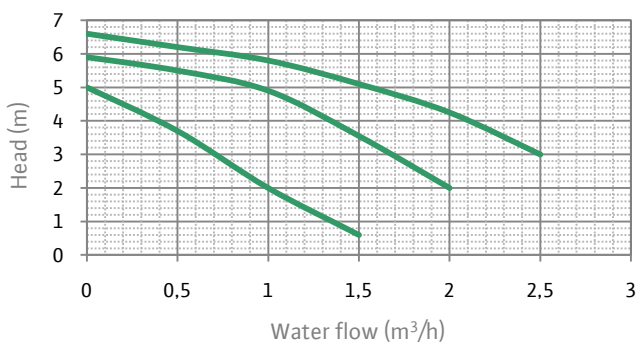

#### \* Test conditions :

- > Water flow rate set at nominal operation point
- > 400 cc air injected
- > Test according to Wilo Intec procedure

Nota bene : tolerances of each curve are according to EN 1151-1:2006

**Wilointec**

50 av. Casella  
F-18700 Aubigny sur Nère  
Tel : +33 2 48 81 62 62  
Fax : +33 2 48 58 20 29  
[www.wilointec.com](http://www.wilointec.com)

[information@wilointec.com](mailto:information@wilointec.com)

**Sales & Marketing Director**

Vincent Fleurier  
Tel : +33 2 48 81 62 74  
Fax : +33 2 48 58 20 29  
[vincent.fleurier@wilointec.com](mailto:vincent.fleurier@wilointec.com)

**Sales Administration Manager**

Véronique Martin  
Tel : +33 2 48 81 62 75  
Fax : +33 2 48 58 20 29  
[veronique.martin@wilointec.com](mailto:veronique.martin@wilointec.com)

**Sales Manager France & Spain**

Robert Carre  
Tel : +33 2 48 81 62 72  
Fax : +33 2 48 58 20 29  
[robert.carre@wilointec.com](mailto:robert.carre@wilointec.com)

**Sales Manager Italy**

Dario Frazza  
Tel : +39 335 762 6181  
Fax : +39 059 286 0855  
[dario.frazza@wilointec.com](mailto:dario.frazza@wilointec.com)

**Sales Manager Subsidiaries**

Gilles Moulin  
Tel : +33 2 48 81 62 25  
Fax : +33 2 48 58 20 29  
[gilles.moulin@wilointec.com](mailto:gilles.moulin@wilointec.com)

**Sales Manager Germany**

Thomas Merscheim  
Tel : +49 172 352 3933  
Fax : +49 231 410 2578  
[thomas.merscheim@wilo.de](mailto:thomas.merscheim@wilo.de)

**Sales Manager UK**

Kevin Padmore  
Tel : +44 776 801 8879  
Fax : +44 128 373 2380  
[kevin.padmore@wilointec.com](mailto:kevin.padmore@wilointec.com)

**Sales Manager Benelux**

Ronald Rijkhoff  
Tel : +31 653 126 749  
Fax : +31 251 215 214  
[ronald.rijkhoff@wilo.nl](mailto:ronald.rijkhoff@wilo.nl)